

S/N	Our part No.	Part No.	Description	Part name	Qty.
1	TBFF0614	0906104-0015	LOCK NUT M8	六角法兰面螺栓M8x16	4
2	507300-013	0507300-0182	LEFT-UP SWING ARM	前左上摇臂	1
3	906160-	0906162-0002	LOCK NUT M10x1.25	六角法兰盘螺母M10x1.25	21
4	507400-013	0507400-0201	LEFT-DOWN SWING ARM	前左下摇臂	1
5		0804004-0023	F.FENDRR SUPPORT	前挡泥板支架	1
6	906104-044	0906104-0044	HEXANGULAR BOLT M10x1.25x60	六角头带盘螺栓M10x1.25x60	8
7	501300-033	0501300-0033	FRONT SHOCK ABSORBER	前减震器	2
8	TBFF1203	0906104-0040	HEXANGULAR BOLT M10x1.25x40	六角头带盘螺栓M10x1.25x40	9
9	804004-033	0804005-0033	LEFT SUPPORT, FRONT FENDER	前挡泥板左支架	1
10		0906104-0006	HEXANGULAR BOLT M6x16	六角头带盘螺栓M6x16	11
11	360200-001	0360200-0001	PROTECT PLATE, ENGINE	方向锁	1
12		0511000-0637	FRAME ASSY	车价焊接总成	1
13	536200-	0536100-0031	FOOTEST	脚踏板	2
14	906104-036	0906104-0036	HEXANGULAR BOLT M10x1.25x25	六角头带盘螺栓M10x1.25x25	4
15	536400-079	0536400-0079	LEFT PEDAL	左护脚网	1
16	530007-003	0530007-0003	LEFT FOOTREST SUPPORT	左搁脚支架	1
17		0801010-0003	SHAFT SUSPENSION	油箱支架	1
18	312100-002	0312100-0002	SINGLE HORN	单喇叭	1
19	512100-062	0512100-0312	BUMPER BAR	保险杠	1
20	904102-001	0904102-0001	BALANCE GRUM	平衡杆胶块	2
21	540300-038B	0540300-0192	Raer shock absorber	后减震器	1
22	430420-005	0430420-0005	REAR BREAK PEDAL SUPPORT	后制动踏板限位支架	1
23	511100-357	0511100-0357	REAR FRAME TAILE	车架后尾段	1
24		0906104-0020	HEXANGULAR BOLT M8x40	六角头带盘螺栓M8x40	8
25	333302-022	0333302-0022	FRONT-RIGHT STEERING LAMP SUPPORT	前右转向灯支架	1
26	805501-013	0805501-0013	R.FENDER L.SUPPORT	后挡泥板左支架	1
27	805502-013	0805502-0013	R.FENDER R.SUPPORT	后挡泥板右支架	1
28	713100-012	0713100-0120	R.CARRIER	后货架	1
29	333402-022	0333402-0022	FRONT-LEFT STEERING LAMP SUPPORT	前左转向灯支架	1
30		0511700-0004	BALANCE BAR	平衡杆	1
31	430510-004	0430510-0004	SWING ARM TIE ROD	转臂拉杆	2
32	540300-038B	0540300-0192	Raer shock absorber	后减震器	1
33	507500-013	0507500-0233	RIGHT-UP SWING ARM	前右上摇臂	1
34	507600-013	0507600-0165	RIGHT-DOWN SWING ARM	前右下摇臂	1
35	430001-	0430001-0004	REAR BRAKE RESET SPRING	后制动回位簧	1
36	430002-001	0430002-0001	REAR BRAKE SWITCH SPRING	后制动开关簧	1
37	530008-003	0530008-0003	RIGHT FOOTREST SUPPORT	右搁脚支架	1
38	536500-079	0536500-0079	RIGHT PEDAL	右护脚网	1
39	430400-069	0430400-0069	REAR BRAKE PEDAL	后制动踏板	1
40	536511-011	0536600-0139	PEDAL NET	护脚网	1
41		0511710-0003	BALANCE PLANTE	平衡杆压板	2
42	507801-001	0507801-00009	Top ball joint		2

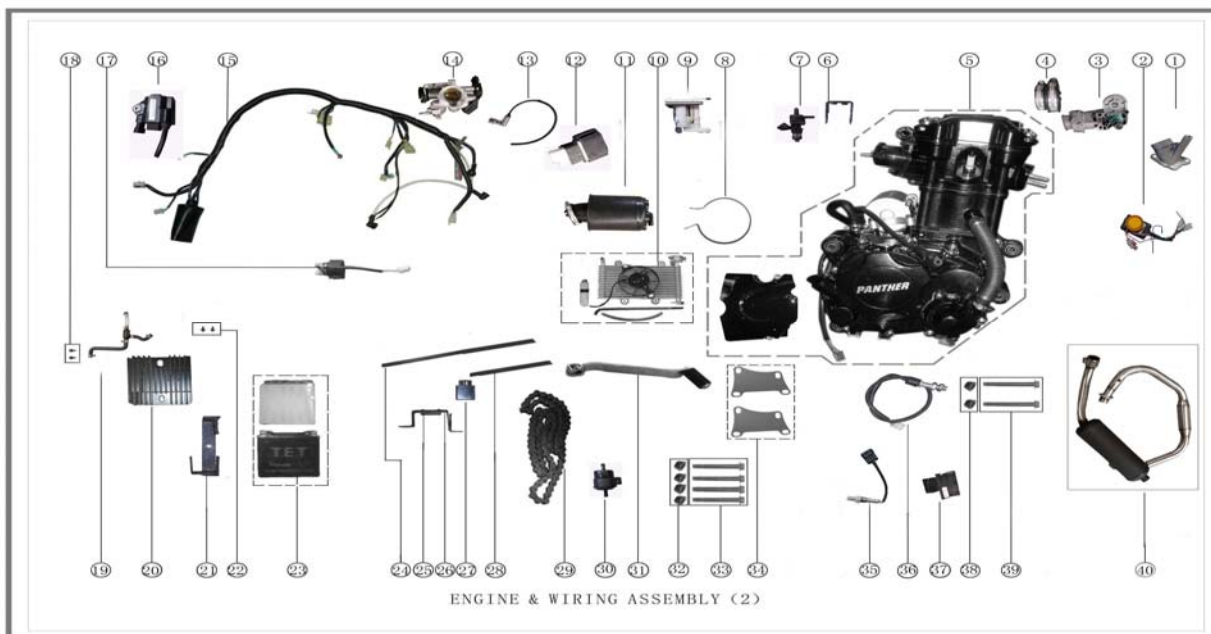

S/N	Part No.	Description	Part name	Qty.	
1	100004-054	0100004-0051	INLET TUBE	进气管	1
2		0311000-0001	ALARM	防盗器组件	1
3	0261230245	0309500-0001	BAROMETRIC PRESSURE SENSOR	大气压力传感器	1
4	100007-003	0100007-0003	INLET TUBE GRUM	进气管胶套	1
5		0110000-0562	MOTOR ASSY	发动机总成	1
6	510001-003	0510001-0013	ENGINE SUPPORT	发动机上悬挂	1
7	161200-002	0161200-0002	OIL ATOMIZER	喷油器	1
8		0170200-0005	FLITTER CLICK	空滤器抱箍	1
9	801600-0001	0801600-0001	FUEL PUMP	油泵	1
10	152000-005	0152000-0032	WATER COOL COMP.	水冷器组件	1
11	171000-073	0171000-0073	AIR FILTER	空滤器	1
12	301500-001	0301500-0001	FUEL PUMP RELAY	油泵继电器	1
13	304200-004	0304200-0004	IGNITION CAP	点火帽	1
14	161400-003	0161400-0003	THROTTLE	节气门总成	1
15	307000-411	0307000-0411	MAIN CABLE COMP	主电缆	1
16	304300-001	0304300-0001	IGNITION COIL	点火线圈本体	1
17	YYPT15025007	0301000-0002	START RELAY	启动继电器	1
18		0906104-0006	HEXANGULAR BOLT M6×16	六角头带盘螺栓M6×16	2
19	162200-008	0162200-0008	OIL-GAS SEPARATOR	油气分离器	2
20	302000-022	0302000-0022	REGULATOR	调压整流器	1
21	305001-001	0305001-0001	STARTER SUPPORT	点火器支架	1
22		0906104-0008	HEXANGULAR BOLT M6×25	六角头带盘螺栓M6×25	2
23		0303100-0004	BATTERY ASSY	蓄电池	1
24		0802002-0008	OIL TUBE	油管	1
25		0303500-0001	BATTERY PLATE GRUM	蓄电池压板胶塞	1
26		0303300-0005	BATTERY PLATE	蓄电池压板	1
27	306500-002	0306500-0002	FLASHER	闪光灯	1
28		0802002-0008	OIL TUBE	油管	1
29	231000-040	0231000-0040	CHAIN	链条	1
30	160100-003	0160100-0003	FUEL FILTER	燃油过滤器	1
31	211000-039	0211000-0039	Shift pedal	换挡踏板	1
32		0906162-0001	HEXANGULAR BOLT M8	六角头法兰面螺母M8	4
33		0906104-0028	HEXANGULAR BOLT M8*90	六角头法兰面螺栓M8*90	4
34		0510012-0011	ENGINE SUPPORT	发动机前悬挂	2
35	200615-18746	0181002-0001	OXYGEN SENSOR	氧传感器	1
36	408000-013-16	0309200-0026	SPEED SENSOR	速度传感器	1
37	17283	0305300-0002	ECU	ECU	1
38	906162-002	0906162-0002	HEXANGULAR BOLT M10	六角头法兰面螺母M10	2
39		0902001-0010	HEXANGULAR BOLT M10*115	六角头轴M10*115	2
40	181000-342	0181000-0342	MUFFLER ASSY	消声器	1

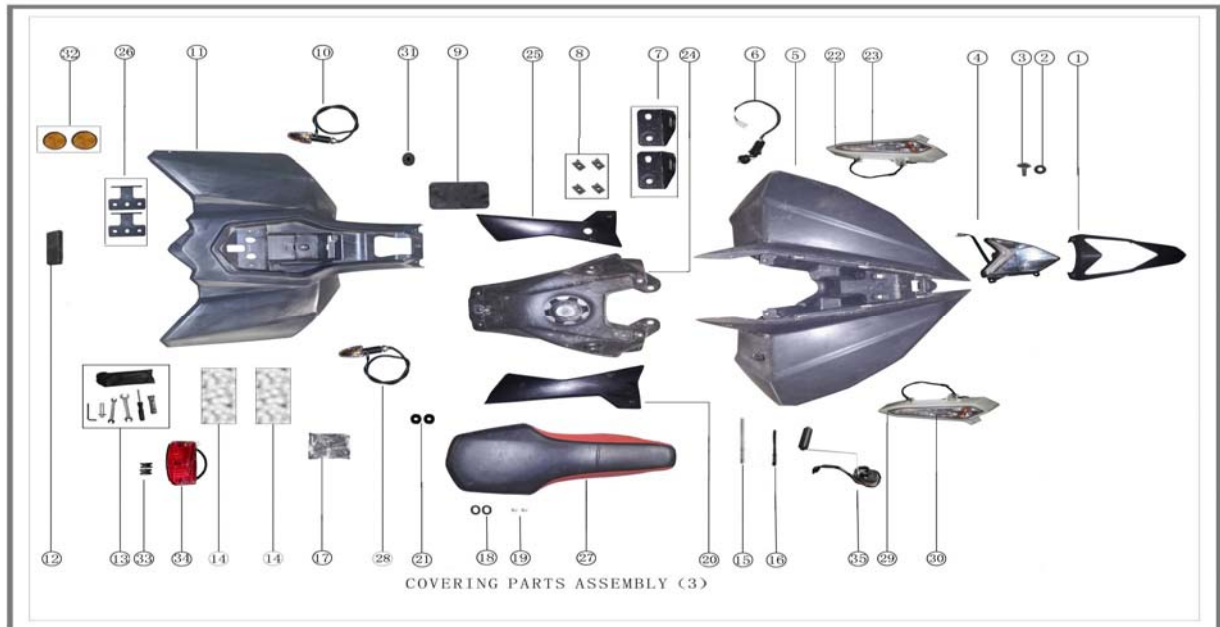

S/N	Part No.	Description	Part name	Qty.	
1	807101-046	0807101-0046	FRONT FENDER	前面罩	1
2		0904229-0006	PAD	胶平垫圈	36
3		0906170-0003	BOLT M6×20	开槽球面大圆柱头螺钉M6×20	36
4	331000-053	0331000-0053	HEAD LIGHT ASSY	前照灯总成	1
5	804100-065	0804100-0650	FRONT FENDER	前挡泥板	1
6	360100-022	0360100-0022	IGNITION SWITCH LOCK	点火开关锁	1
7		0800005-0002	TANK COVER SUPPORT	油箱护板支架	2
8		0906181-0002	NUT CLICK	螺母夹	4
9		0303400-0001	BATTERY GASKET	蓄电池缓冲胶垫	1
10	333600-017	0333600-0017	REAR-LEFT STEERING LAMP	后左转向灯	1
11	805100-089	0805100-0894	REAR FENDER	后挡泥板	1
12	QBK-32600-0000	0306400-0001	REAR REFLECTOR	后反射器	2
13		0902001-0010	TOOLS	随车工具	1
14		0905606-0002	Battery foam	蓄电池泡沫	2
15		0904101-0025	BAND	扎带	1
16		0904101-0003	BAND	扎带	1
17		0186000-0009	HEAT-INSULATION CUSHION	隔热垫	1
18		0904222-0007	H-RUBBER	工字胶	2
19		0902007-0012	FLANGING BUSH	翻边衬套	2
20	800620-002	0800620-0002	R.TANK COVER	油箱右护板	1
21		0904222-0006	H-RUBBER	工字胶	2
22		0333800-0001	L.TURN LIGHT SUPPORT	左转向灯支撑	1
23	333400-018	0333400-0018	FRONT-LEFT STEERING LAMP	前左转向灯	1
24	801000-003	080100A-0003	FUEL TANK ASSY	油箱总成	1
25	800610-002	0800610-0002	L.TANK COVER	油箱左护板	1
26		0306004-0005	R.RELECTOR SUPPORT	后反射器支架	2
27	701000-1129	0701000-1129	SEAT CUSHION	座垫	1
28	333700-017	0333700-0017	REAR-RIGHT STEERING LAMP	后右转向灯	1
29		0333810-0001	R.TURN LIGHT SUPPORT	右转向灯支撑	1
30		0333500-0018	FRONT-RIGHT STEERING LAMP	前右转向灯	1
31		0904107-0028	RUBBER GASKET	胶垫	1
32		0306102-0004	R.RELECTOR	后侧光片	2
33		0904222-0008	H-RUBBER	工字胶	3
34		0332000-0043	TAIL LIGHT COMP.	尾灯总成	1
35	308500-009	0308500-0009	OIL SENSOR	燃油传感器	1

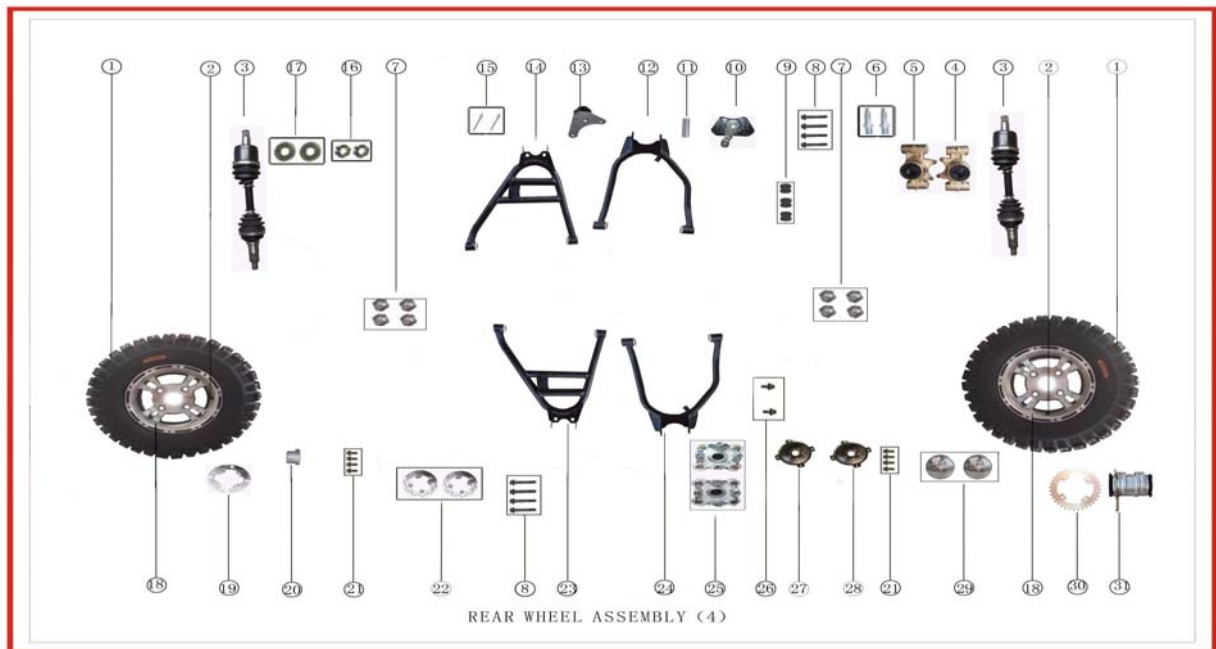

S/N	Part No.	Description	Part name	Qty.	
1	408000-009	0408000-0100	REAR TYRE	后轮胎	2
2		0400300-0001	INFLATING VALVE	气门嘴	2
3	246010-011	0246010-0011	BALL CAGE HALF SHAFT	球笼半轴	2
4	508200-002	0508200-0002	SUPPORT BODY,REAR-RIGHT WHEEL AXLE		1
5	508100-002	0508100-0002	SUPPORT BODY,REAR-LEFT WHEEL AXLE		1
6	902003-004	0902003-0004	DOUBLE SHAFT	双头轴	2
7	906213-007	0906213-0007	NUT M10	锥度螺母M10	8
8		0906104-0044	HEXANGULAR BOLT M10×60	六角头带盘螺栓M10×60	8
9		0906300-0001	PLASTIC CLICK	塑料卡子	3
10	444000-002	0444000-0002	Rear brake caliper	驻车泵	1
11	902009-011	0902009-0011	BUSH	衬管	1
12	506100-008	0506100-0008	LEFT-UP SWING ARM	后左上摇臂	1
13	444001-003	0444001-0003	MOUNTING BRACKET OF VEHICLE PUM	驻车泵安装支架	1
14	506400-003	0506400-0003	R. RIGHT-DOWN SWING ARM	后右下摇臂	1
15		0906171-0006	PIN CUTTER	开口销3×40	2
16	906108-018	0246010-0012-1	NUT M18*1.5	后开槽螺母M18*1.5	2
17	906215-041	0906215-0041	NON-STANDERD GASKET	非标垫圈	2
18	405000-119	0405000-0119	REAR HUB	后轮毂	2
19	444002-001	0444002-0001	PARKING BREAK DISC	驻车制动盘	1
20	243033-025	0243033-0025	REAR BREIDEG COVER	后桥衬套	1
21		0906104-0015	HEXANGULAR BOLT M8×16	六角头带盘螺栓M8×16	8
22	442001-034	0442001-0034	REAR BRAKE DISC	后碟刹盘	2
23	506200-003	0506200-0003	LEFT-DOWN SWING ARM	后左下摇臂	1
24	506300-003	0506300-0003	RIGHT-UP SWING ARM/ Rear	后右上摇臂	1
25	243010-083	0243010-0083	REAR TYRE CONNECT PLATE	后轮连接盘	2
26		0906104-0006	HEXANGULAR BOLT M6×16	六角头带盘螺栓M6×16	2
27	243016-030	0243016-0030	REAR BRIDGE DISC BREAK BASE	后桥碟刹座	1
28	405101-0031	0405101-0031	CHAIN WHELL BASE	链轮座	1
29	904206-007	0904206-0007	DUSTPROOF RUBBER BOOT	防尘护套	2
30	405100-76	0405100-0076	SPROCKET WHELL	链轮	1
31	243065-002	0243065-0002	DIFFIRENCIAL ASSY	差速器总成	1

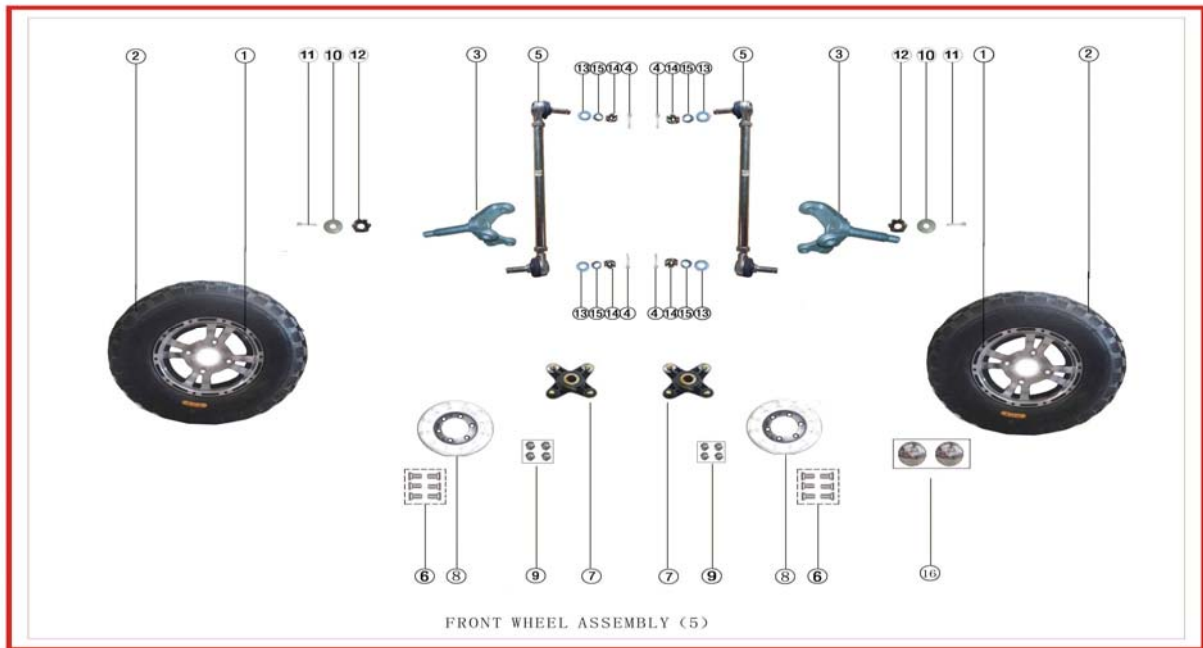

S/N	Part No.	Description	Part name	Qty.	
1	401000-124	0401000-0124	FRONT TYRE HUB	前轮毂	2
2	404000-036	0404000-0102	FRONT TYRE	前轮胎	2
3	505000-005	0505000-0025	KNUCKLE ASSY	转向节部件	1
4		0906171-0002	PIN CUTTER	开口销2x20	4
5	430500-	0430500-0041	TIE ROD ASSY	转向拉杆组件	1
6	906174-001	0906174-0001	CROSS BOLT M6X16	十字槽沉头螺钉M6x16	12
7	441600-018	0441600-0018	FRONT DISC SEAT	前碟刹基座	2
8	441001-017	0441001-0017	FRONT BRAKE DISC	前碟刹盘	2
9	906160-	0906213-0007	NUT M10	锥度螺母 M10	8
10		0906215-0003	WASHER	非标垫圈 φ16.5×φ50×3	2
11		0906171-0006	PIN CUTTER	开口销	2
12	MK14X1-5	0906108-0001	CONE SLOT OF OPEN NUT MODEL	1型六角开槽螺母M14	2
13		0906152-0014	WASHER10	平垫圈10	2
14	906108-002	0906108-0002	CONE SLOT OF OPEN NUT MODEL	1型六角开槽螺母M10	2
15		0906151-0004	GASKET10	弹垫圈10	2
16		0904206-0007	COVER	防尘护套	2

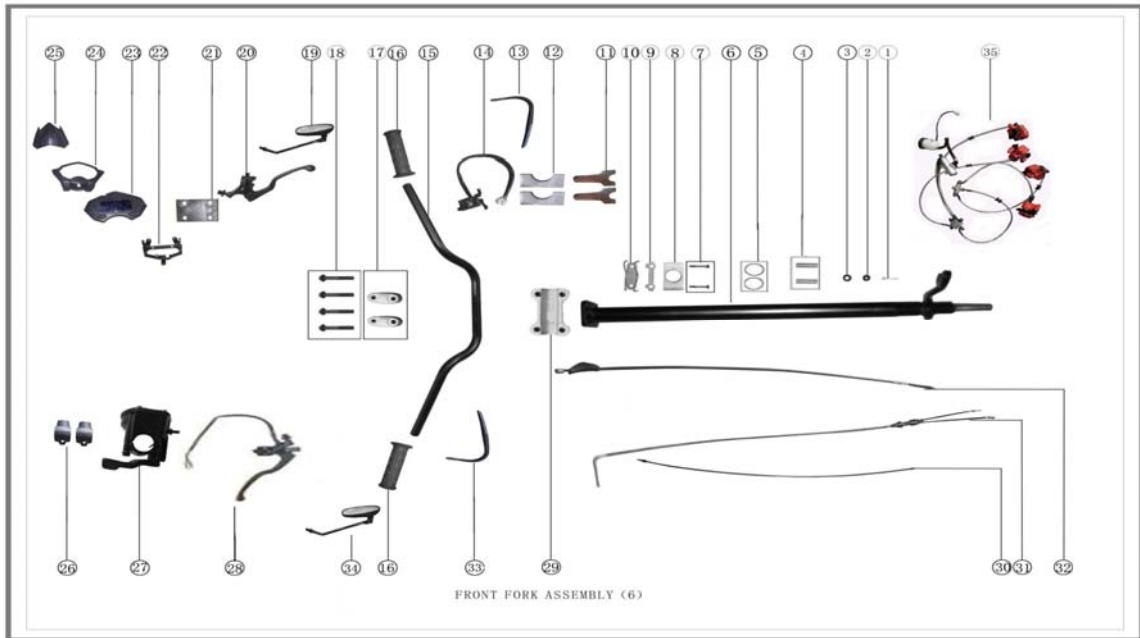

S/N	Part No.	Description	Part name	Qty.	
1	0906171-0002	PIN CUTTER 2,5x30	开口销2x20	1	
2	0906108-0002	CONE SLOT OF OPEN NUT MODEL M10	1型六角开槽螺母M10	1	
3	0906152-0005	GASKET10	平垫圈10	1	
4	0503302-0001	BUSH,STEERING ROD CLIP	方向柱卡子衬管	2	
5	0503309-0001	GASKET, HANDLE BAR CLIP	方向柱卡子密封圈	2	
6	503300-016	0503300-0047	STEERING STEM	方向柱	1
7	0906101-0003	HEXANGULAR BOLT M8×60	六角螺栓M8×60	2	
8	503301-	0503301-0003	STEERING ROD CLIP	方向柱卡子	2
9	503306-	0503002-0001	STEERING STEM CLIP WASHER	方向柱卡垫	1
10	503306-	0503306-0002	WIRE CLIP OF STEERING STEM	方向柱线卡	1
11		0600003-0001	CLIP,HANDLE BAR PROTECT	手柄挡风罩卡子	2
12	600004-	0600004-0001	SEAT,HANDLE BAR PROTECT	手柄挡风罩卡座	2
13	370100-001	0370100-0014	LEFT HANDLEBAR PROTECTOR	左手柄挡风罩	1
14	371100-056	0371100-0056	LEFT HANDLEBAR SWITCH	左闸把开关	1
15	600001-020	0600001-0135	HANDLEBAR	手把管	1
16	600100-001	0904303-0001	Rubber grip	手把胶	2
17	503001-002	0503001-0002	CLIP, HANDLE BAR	方向把卡子	2
18		0906104-0033	HEXANGULAR BOLT M8×1×55	六角头带盘螺栓M8×1×55	4
19	901400-074	0901100-0074	LEFT REARVIEW MIRROR	左后视镜	1
20	372100-005	0372100-0005	LEFT HANDLE COMP	左手柄组件	1
21		0350202-0001	METER DOWN SUPPORT	仪表下支架	1
22		0350201-0001	METER UPMETER	仪表上支架	1
23	351000-059	0351000-0059	INSTRUMENT ASSY	仪表总成	1
24	351030-008	0351030-0008	METER R.COVER	仪表后罩	1
25	351021-027	0351021-0006	METER F.COVER	仪表前罩	1
26		0901010-0001	CLIP,MIRROR SEAT	镜座卡子	2
27	600201-007	0600201-0003	THROTTLE ASSY	加油器	1
28	372200-006	0372200-0006	RIGHT HANDLE COMP	右手柄组件	1
29	503200-003	0503200-0003	HELEE,HANDLE UNDER	方向把卡座	1
30	430600-029	0430600-0029	R.BREAK CABLE	后制动拉索	1
31	607000-076	0607000-0076	CABLE,THROTTLE	油门线	1
32	606000-004	0606000-0004	Clutch CABLE	离合器拉索	1
33	370200-001	0370200-0001	RIGHT HANDLEBAR PROTECTOR	右手柄挡风罩	1
34	901200-075	0901200-0075	RIGHT REARVIEW MIRROR	右后视镜	1
35		0443000-0058	DISK BRAKE ASSY	碟刹总成	1
		53510-329		jobb hátsó féknyereg	
		53520-329		bal hátsó féknyereg	
		53510-329A		bal első féknyereg	
		53520-329A		jobb első féknyereg	
		53560-329-S7		Főfékhenger	
		TBFF0589		fékáteresztő csavar 10x22x1,25	
		53540-329-S7		fékelosztó	
		9A-53540-8A		Fékcső áteresztő csavar 10x35x1,25	
		53512-329		első fékcső	
		53513-329		Fékcső 120 cm (főfékhenger első elosztó között)	
		53511-329		Hátsó fékcső 50 cm	
		53514-329		összekötő fékcső 32 cm	
		F19-51004-0		fékcső tartó	



S/N		Part No.	Description	Part name	Qty.
1		024012-0004	Adjusting shim d:30		2
2	151400-024	0151400-0024	Oil seal 24x32x4		2
3	902005-098	0902005-0098	Bush 30x25x10x		2
4	243087-001	0243087-0001	Axle gear		2
5	243088-001	0243088-0001	Planet gear		5
6	243016-030	0243016-0030	Rear axle disc brake base		1
7	902012-128	0902012-0128	Bearong d:100		2
8	151400-025	0151400-0025	Oil seal 75x100x9		2
9	243089-001	0243089-0001	Differential housing		1
10		0507002-0001	Butter mouth		1
11		0243017-0020	Rear axle brake bracket		1
12	243090-001	0243090-0001	Differential left half shell		1
13		0906130-0003	Elastic pad d:8		18
14		0906172-0009	Hexangular bolt M8x25		6
15	906153-018	0906153-0018	Circlip for shaft d:10		1
16		0906103-0005	Hexangular bolt M8x20		12
17	243091-001	0243091-0001	Differential right half shell		1
18		0902018-0023	Axle d:12		1
19	405101-0031	0405101-0031	Sprocket wheel basic		1